

Stage Impact, Large fabric walls

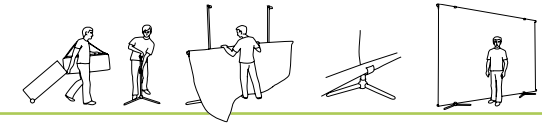

Stage 5x2, 550x225 cm



Specifications: Stage Impact

CONSTRUCTION
Alloyed aluminium profiles

VARIATIONS
Straight, Curved, S-shaped, Hanging, Trade Fair

GRAPHIC MATERIAL
Textile graphics

WIDTH
Variable depending on the variation
Straight, Curved:
from 4.4 meters
Trade Fair: from 4x2 sqm

HEIGHT
Straight, Curved, S-shaped and Trade Fair: 2.25 m - 2.5 m

WEIGHT
From 15 kg

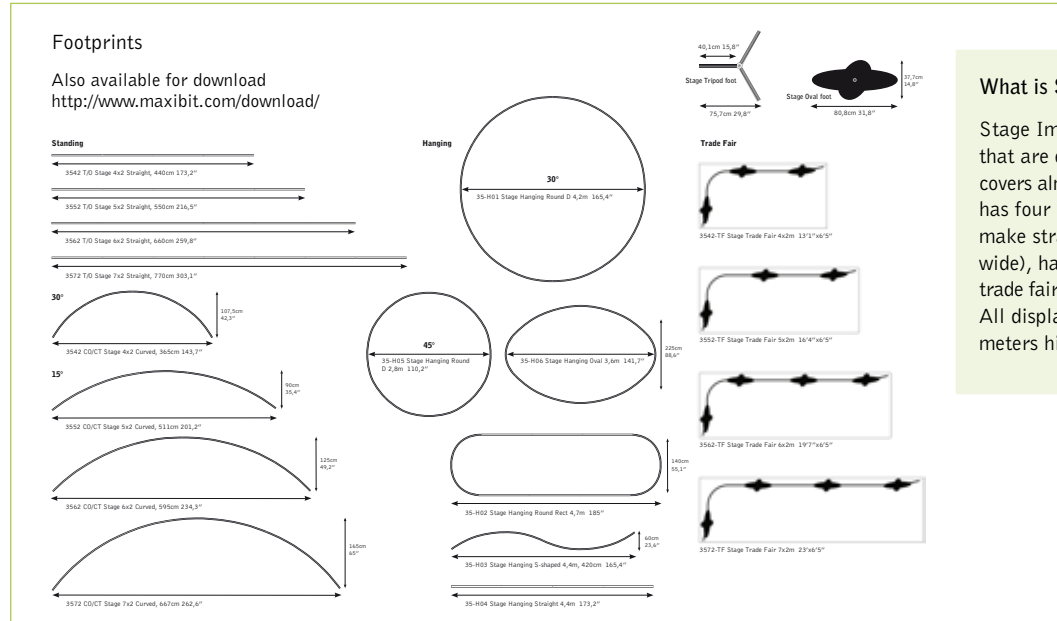

What is Stage Impact?

Stage Impact is a collection of Stage displays that are easy to use and quick to set up. The range covers almost every marketing need. Stage Impact has four variations. With these variations, you can make straight or curved walls (4.40 - 7.70 meters wide), hanging shapes in various formations and trade fair displays that range from 4x2 - 7x2 meters. All displays are 2.25 and can be extended to 2.50 meters high. Stage Standard is simple and elegant.

Why choose Stage Impact:

- Fabric is the future. Get tomorrow's technology today
- Stage is unique to Maxibit
- Stage is perfect for public spaces, congresses, company events and trade fairs
- Stage is compact to transport and gives you a huge marketing surface area



Stage Modular, Unique stage experiences

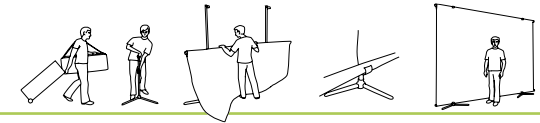

Stage 330x350 cm

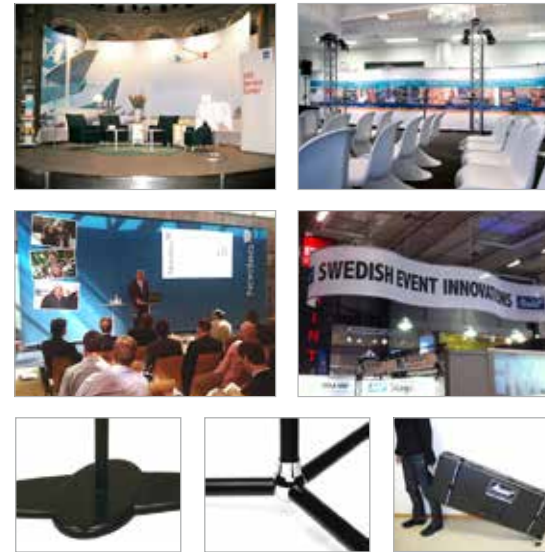

Specifications: Stage Modular

PARTS AVAILABLE
 Complete pole kits (Oval or tripod foot)
 Vertical extension poles (110 cm)
 Horizontal profile 2 pack (110 cm):
 Straight, 90, 45, 30, 15 degrees
 Horizontal profile 2 pack (45.5 cm):
 90 degrees
 Holders and hangers, Bags, Light

CONNECTORS
 All horizontal poles can be inserted into each other and are held tight by magnets. Vertical poles screw together.

POLE HEIGHT
 Customisable height: All poles come in a standard height of 2,25 cm. Can be extended in lots of 1.10 meters

WIDTH
 Customisable width. Build as long as you want. Starting at 1.10 meters and extendible in width in lots of 1.10 meters

Footprints

Also available for download
<http://www.maxibit.com/download/>

How big do you want it?

Stage Modular is the perfect solution for you who wants to build large marketing surfaces on your own terms. Stage Modular is a selection of loose Stage parts that allows you to quickly assemble a Stage backdrop or hanging creation in any number of shapes, sizes and curves. Stage Modular allows you to build in terms of height, width and various curvatures. Heavy duty hangers allow you to hang everything from the ceiling.

Why choose Stage Modular:

- Stage Modular is perfect for those with Stage experience that want a great custom effect
- Perfect for spaces that aren't conventional
- Ideal for large spaces such as scenes and convention halls
- Great for creating your own marketing space tailored to your brand



Maxibit has been a member of UN Global Compact since 2007, www.unglobalcompact.com.



Scene UltraLight, Flexible fabrics



Specifications: Scene UltraLight

CONSTRUCTION

Alloyed aluminium profiles.

VARIATIONS:

Straight, curved or Bit'a'Both (curved and straight)

GRAPHIC MATERIAL:

Textile graphics

WIDTH:

3 meters

HEIGHT:

Backdrop/Bannerstand: 2.25 meters

WEIGHT:

9 kg
(weight is complete with case and graphic)

Footprints

Example of variations

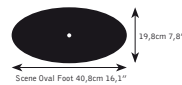
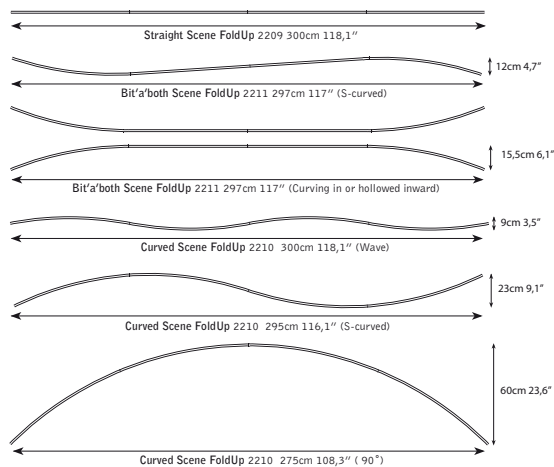

What is Scene UltraLight?

Scene UltraLight is a selection of innovative stretch fabric displays that are light and mobile. Making your next event stressfree, Scene UltraLight's backdrop uses the latest in fabric print to give you a flexible display that can be transported easy. Set up in minutes, you can have a curved, straight or Bit'a'Both backdrop that perfectly frames your booth. Scene UltraLight is available in ready-to-deploy kits!

Ready, steady, go!

Why choose Scene UltraLight:

- Light weight and impressive size (3 x 2,25 meters)
- Easy to transport and simple to setup
- Ready-to-deploy kits that are perfect for public events, mobile campaigns and taste-testings
- Flexible shapes with the latest technology

Website



YouTube setup manual



Maxibit has been a member of UN Global Compact since 2007, www.unglobalcompact.com.



www.maxibit.com

Scene Modular, Customised fabrics

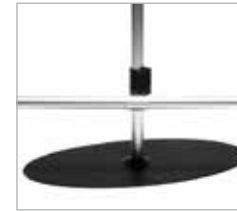

Specifications: Scene Modular

PARTS AVAILABLE:

- Foot with pole (tripod and oval)
- Straight horizontal poles (2 pack): 50, 75, 100 cm
- Straight horizontal poles (50 pack): 50, 75, 100 cm
- Hanger clips (2-pack)
- Bag for 50 and 75 cm poles and foot
- Bag for 100 cm poles and foot
- I-lite

CONNECTORS: All horizontal poles can be screwed to together

POLE HEIGHT: Pole is extendable from 88 to 225 cm

WIDTH: Customisable width. Build as long as you want. Starting at 50 cm and available in increments of 25 cm.

Footprints

Scene Tripod Foot 59cm 23,2"

Scene Oval Foot 40,8cm 16,1"

Note: Ideally poles are to be placed every 2 meters

Standard

50cm 19,7"

Example of variations

50cm 19,7" | 100cm 39,4" | 75cm 29,5"

75cm 29,5"

75cm 29,5" | 75cm 29,5" | 75cm 29,5"

100cm 39,4" | 50cm 19,7" | 50cm 19,7" | 100cm 39,4" | 100cm 39,4"

What is Scene Modular?

Scene Modular is a selection of parts that enables you to build custom scene banners in increments of 25 cm widths. Starting at 50 cm, you can build as wide as you like. All horizontal poles screw quickly together giving you flexibility to change the size of your booth when you need to. Scene Modular can also be deployed as a hanging solution in the width and height of your choice.

Why choose Scene Modular:

- Customised to your unique need
- Build light weight flexible banners that are easy to transport
- Perfect for smaller public events, taste-testings and career days
- Hang from the ceiling
- Make backdrops or bannerstands



Performance, a new Pop-up system

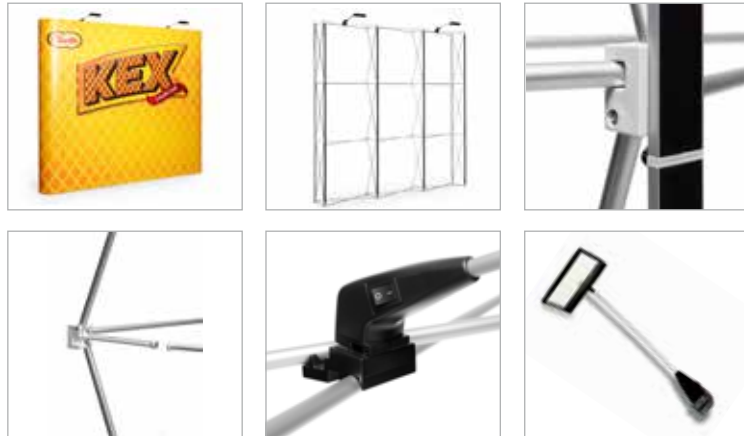
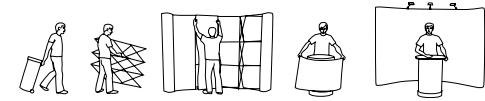

Specifications: Performance

CONSTRUCTION
Aluminum profiles with folding magnetic channel bars

VARIATIONS:
Straight and Curved

GRAPHIC MATERIAL:
Laminated paper or digital transparencies, matte or glossy.

WIDTH:
Curved: from 125 cm up to 405 cm
Straight: from 129 cm up to 430 cm

HEIGHT:
230 cm

WEIGHT:
3x3 section: 15 kg including graphic

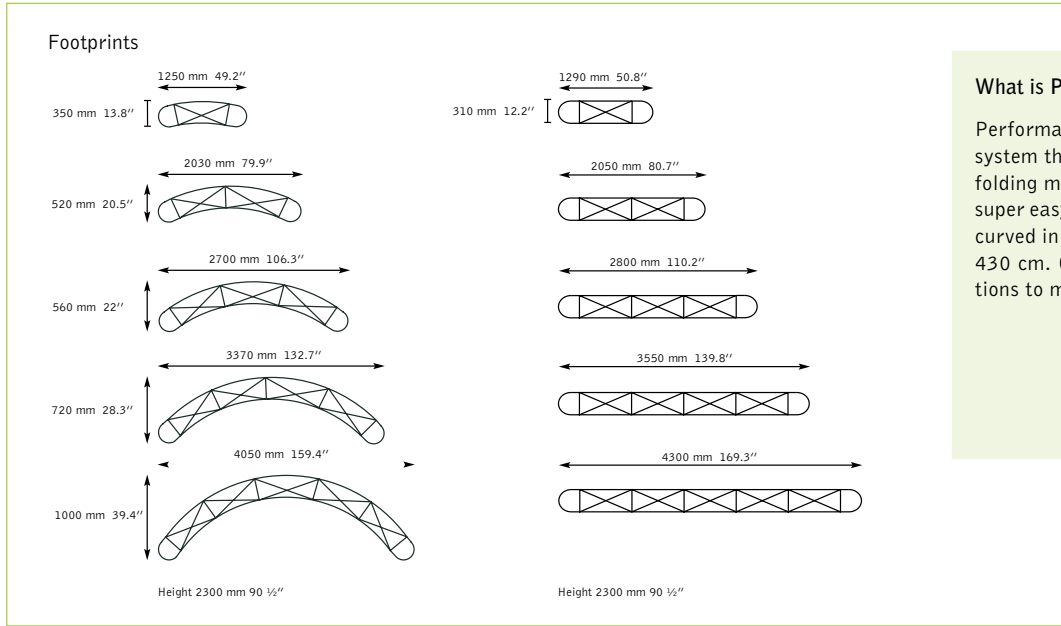

What is Performance?

Performance is a compact and versatile pop-up system that is quick to set up at any location. The folding magnetic channel bars makes the assemble super easy. Performance is available in straight or curved in a number of widths, from 125 cm up to 430 cm. Choose double or single sided configurations to meet any space requirement.

Why choose Performance:

- Quick to set up and easy to mount graphic
- Continuous seamless graphic
- Folding magnetic channel bars
- Clean design with a professional look
- Single or double sided

Network & NW Frost, Pop-up system



Specifications: Network & NW Frost

VERSIONS

Straight, Curved, S-shaped, Square Edge, custom heights.

CONSTRUCTION

Aluminium pop-up system. The system, graphics, lights extension cord and accessories are transported in the All-in-One Podium.

GRAPHIC MATERIAL

Laminated paper or digital transparencies, matte or glossy.

GRAPHIC SIZE

Front panel: 68x223.5 cm. Side panel: 66x223.5 cm.
 SquareEdge: 30.1x223.5 cm. Back panel: 80x223.5 cm.
 Straight panel: 73.3x223.5 cm.
 Display counter (All-in-One): 163x85 cm.

WIDTH

Four sections = 320 cm.

HEIGHT

Three sections = 225 cm.

DEPTH

Each section is about 30 cm deep.

WEIGHT

4x3 sections = 33 kg incl. graphics, lights and display counter.

Footprints

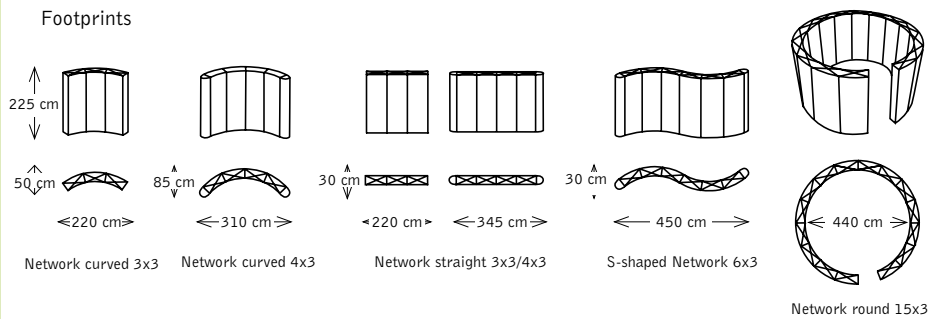

Ideas

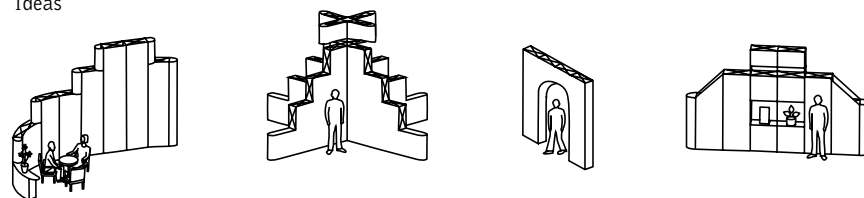

Seamless graphic precision

Network is a very compact and versatile pop-up system that is quick to set up at any location. It allows you to meet your customers where they are, rather than having them come to you. Network can be designed in a number of different shapes; straight, curved, wave-shaped, stair formations, double or single sided and many more.

With Network Frost, you can turn the standard display system into a refined shelving system for a walk around experience of your displayed products.

Why choose a Network

- Unlimited layout options
- Continuous seamless graphics
- Quick to set up and easy to mount graphics
- Stable design with a professional look
- Adjustable feet for uneven floor
- Create showcases with Network Frost™ shelves

Website



YouTube setup manual



Maxibit has been a member of UN Global Compact since 2007, www.unglobalcompact.com.



www.maxibit.com

Maxibit LaunchPack

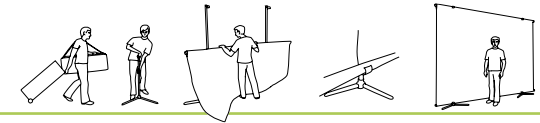

Specifications: LaunchPack

VERSIONS
LaunchPack, CookPack; Sound-Pack, ShowPack

MATERIAL
100% recycled plastic, Aluminum, rubber

SIZE (LxWxH)
Desk size: 101x61x103 cm
Case size: 101 x61 27 cm

WEIGHT
17 kg

Footprints

LaunchPack top: 101 cm width, 61 cm height

LaunchPack front: 101 cm width, 103 cm height

LaunchPack back: 101 cm width, 103 cm height

Variations

CookPack top ShowPack top SoundPack top

Point-of-Sale Perfection

LaunchPack is everyone's Point-of-Sales dream. With its hollow insides you can transport the very best of Maxibit's designer P.O.S booths. The casing is made of 100% recycled plastic and has room for among other things, literature and sample products. It's streamline design allows it to be taken anywhere.

Why LaunchPack

- All-in-one desk and transport case with inner-shelf
- Unique suitcase design for easy transportation
- Perfect Point-of- Sales with stove, music and display case variations
- Hollow transportation shells can transport products, displays etc



All-in-One Case



Specifications: All-in-One Case

DESCRIPTION

A durable transportation box that can be turned into a counter.

SIZE

Podium size:
100x74x49 cm

Double Podium size:
100x176x66 cm

Case size:
99x59x43 cm

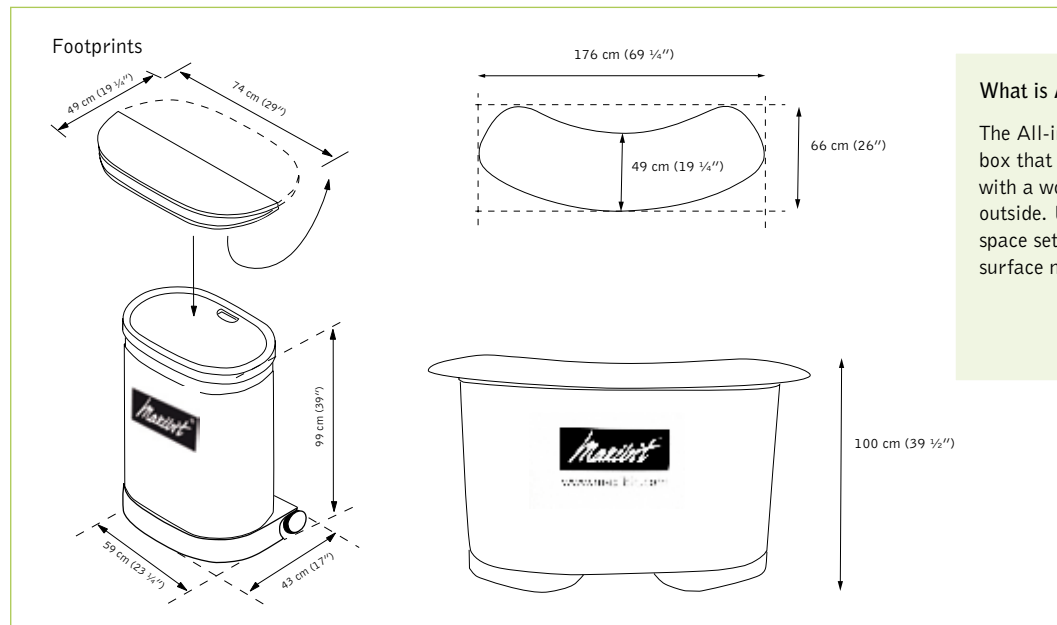

What is All-in-One?

The All-in-One Case is a durable transportation box that easily can be turned into a counter with a wooden top and a graphic wrap on the outside. Use a single All-in-One Case for small space settings or a double All-in-One for larger surface needs.

Why choose All-in-One?

- Built-in wheels and carry handle for easy handling
- Wooden folding top in black with exclusive brass hinges
- Graphic display area
- All-in-One is perfect for transportation of Performance, banner stands and Scene UltraLight



Maxibit has been a member of UN Global Compact since 2007, www.unglobalcompact.com.



www.maxibit.com

Strengthen your brand with Zap D2 and Zap D3



Specifications: Zap

VERSIONS
 Zap D2 (850), Zap D2 (1185)
 Zap D3 (850), Zap D3 (1185)

DESCRIPTION
 Aluminum alloy Roll-up with telescopic pole, Gripper profile and fast cassette-loading graphics. Flight Bag with pocket for spotlight.

GRAPHIC MATERIAL
 All common materials, e.g. polyester.

WIDTH
 850 mm and 1185 mm.

HEIGHT
 Standard 2250 mm (adjustable, 900–3000 mm).

WEIGHT
 Approx. 4 kg with graphics and flight bag.

Footprints

Ideas

What's your best choice of roll-up?

There is a significant difference between Zap and other roll-ups. With Zap D2 and D3, you can be assured that your message is delivered with the strongest impact and the highest quality. Zap comes in two designs. D2 is the most compact while D3 has no visible, protruding foot on the floor. Zap is 100% recyclable for a better environment. With Zap D2 and D3 you will always be prepared – meet your customer whenever, wherever. When it's time for your next campaign, you can change your message in less than a minute without the need for tools.

Why should I choose Zap

- Clever Gripper profile
- Fast and easy graphics exchange
- Adjustable with a quality Swedish design
- 2 designs and 2 widths; 4 versions
- Generous graphic dimensions
- Adjustable height, 900–3000 mm
- Drop-in pole cup for easy set-up
- Excellent for the environment; re-usable and recyclable
- Accessories: Spotlight, brochure holder, presentation desk

Website

Maxibit has been a member of UN Global Compact since 2007, www.unglobalcompact.com.

www.maxibit.com

Solo Banner Stand

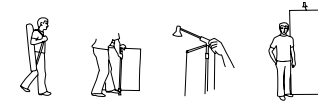

Solo 1



Solo 3



Specifications: Solo

VERSIONS
 Solo 1 850/610 mm
 Solo 3 850/610 mm

DESCRIPTION
 Aluminum alloy banner stand with telescopic pole. Re-usable Gripper profiles for snap-in graphics. Flight Bag with pocket for spotlight.

GRAPHIC MATERIAL
 All common materials, e.g. polyester.

WIDTH
 850/610 mm.

HEIGHT
 Adjustable up to 225 cm.

WEIGHT
 1.2 kg excl. graphics and flight bag.

Footprints

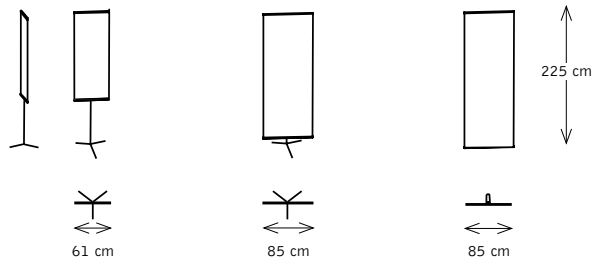

Ideas

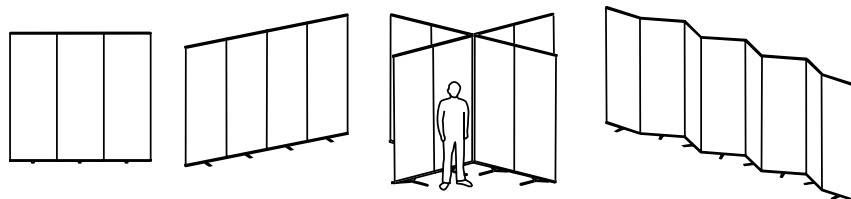

What's your best choice of banner stand?

Solo is ultra-compact, yet fully equipped like no other. The Solo 1 and Solo 3 banner stands have unique, clever features for your successful campaigns. Solo 1 has no visible foot on the floor. Solo 3 has an elegant, fold-out tripod foot. The telescopic pole and a bottom slider give height to be adjusted to fit your preferences. Solo can be seamlessly connected side by side, straight or at an angle, thanks to built-in power-magnets. Clever Gripper profiles allow for fast and easy graphics exchange without tools or tape. Solo is 100% re-usable and recyclable, kind to the environment.

Why should I choose Solo

- Clever Gripper profiles for the easiest graphics exchange
- Ultra-compact for smart carrying
- Adjustable height, top profile 1000–2250 mm, bottom profile 0–750mm
- 2 designs, 2 widths, 4 versions
- Multiple Solos side by side create impressive larger backdrops
- Built-in power-magnets allow for straight or angled lineup
- Accessories: Spotlight, brochure-holder, presentation desk

Website



Maxibit has been a member of UN Global Compact since 2007, www.unglobalcompact.com.



www.maxibit.com

Beach Flag

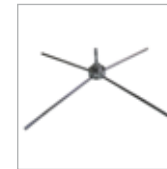

Specifications: Beach Flag

DESCRIPTION

Portable outdoor solution.

HEIGHT

Three different heights:

2.5 m

3.4 m

4.7 m

WEIGHT

Weight starts at 1.8 kg incl. carry bag

Footprint



What is Beach Flag?

Maxibit's BeachFlags are the ideal advertising solution when it comes to outdoor events. Setting up the Beach Flag is easy thanks to our range of custom bases for snow, beach, grass or concrete. The flag is available in 3 different sizes, to ensure the best solution for displaying your company logo or message.

Why choose a Beach Flag:

- Creates high visual impact
- Easy to transport and set up in any desired environment
- The rounded corner design ensures that the fabric is stretched tight and the pole stays straight.
- All Beach Flags come complete with a carry bag
- 100% recyclable material for a better environment



Maxibit has been a member of UN Global Compact since 2007, www.unglobalcompact.com.



www.maxibit.com

Eagle, Brochure Stand



Specifications: Eagle

DESCRIPTION
Portable brochure stand with 4 brochure holders.

SIZE STANDING
L27 x W24.5 x H156 cm.

SIZE PACKED DOWN
L27 x W24.5 x H40 cm.

POCKET SIZE INTERIOR
21.6 cm x 33 cm, suitable for A4 brochures.

WEIGHT
4.2 kg.

Footprint

Height 156 cm

24.5 cm

27 cm

Easy to bring every where

Sturdy nylon bag

Travels with the brochures

Long-lasting and user-friendly

Eagle has been engineered to be the perfect compliment to any marketing display. Its timeless design and quick set up means that it can be deployed any time and anywhere. Its small foot-print and low centre of gravity allows it to be placed in the most crowded areas but for maximum impact the system is best used in tandem with other products in the Maxibit range. For the campaign trail, use Eagle with Maxibit Zap for a subtle yet powerful shopping mall display, while at the trade fair, several Eagle used side by side can add elegance to your booth.

Why choose a Eagle

- Quick to set up with auto-locking mechanism
- Works in any environment
- Comes in two different colours
- One of the lightest brochure holders available
- Brochures can be transported safe in the stand
- Delivered in handy nylon carrying bag



iPad Stand



Specifications: iPad Stand

DESCRIPTION
Lightweight lockable stand for your iPad tablet.

WIDTH
49.5 cm

HEIGHT
117 cm

WEIGHT
2 kg

Footprint

Height 117 cm (46")

49.5 cm (19")

What is iPad Stand?

The iPad Stand is a lightweight lockable stand for your iPad tablet. It's a versatile and functional stand that can be used with iPad 2, iPad 3 and iPad 4 in any environment. The angle can be adjusted and the iPad can be displayed in both landscape and portrait orientation. The sturdy tripod foot ensures total stability.

Why choose a iPad Stand?

- Quick to set up and easy to carry
- Works in any indoor environment
- Rotates 360° for portrait or landscape orientation
- Lockable holder to secure your iPad tablet

Stage Table



Specifications: Stage Table	
DESCRIPTION	A portable bar height cafe table
WIDTH	49.5 cm
HEIGHT	96 cm
WEIGHT	8 kg

Footprint

49.5 cm (49")

Height 96 cm (37 3/4)

What is Stage Table?

The Stage Table is a modern version of a bar height cafe table that is collapsible, light to carry and easy to set up. The table is a perfect meeting point at any event. Use a single table or in a group, together with a backdrop wall or on its own.

Why choose a iPad Stand?

- Intuitive and easy set up
- Large base for maximum stability
- Completely collapsible and portable
- Delivered in two nylon carry bags



www.maxibit.com

Maxibit has been a member of UN Global Compact since 2007, www.unglobalcompact.com.